

## SleekTone CC

P/N:STCC-XXW

### Constant Current Module

Tunable White / Dim to Warm Control

The SleekTone-CC is a compact control module that allows connection of any third party LED Driver to a AmbientTech Tunable White control system. It is available in 30W, 45W and 60W versions. With an input range of 4-60VDC it is compatible with any standard constant current 0-10V LED Driver.

The SleekTone module utilizes a wireless 433mhz RF signal for room level control using the DimTone dual slider wall switch. The DimTone wall switch is able to control multiple modules and offers app and voice control (WIFI+BLE). Eliminating the need of running 0-10V wires in new installations.

The Modules small form factor enables lighting OEMs to easily implement AmbientTech's control system in to LED fixtures without the need for design modifications. This line of modules offers a status LED indicator and physical buttons to easily pair to our wall switches , app and voice control. In addition, the buttons are used to configure dimming and CCT mixing curves.



Tunable White



Dim to Warm



Dimmable  
0%-100%



RF CONTROL

4-60VDC



SmartAir WiFi



Production Housing



Engineering Sample

#### ENCLOSURE DETAILS

|            |   |
|------------|---|
| Dimensions | 3.14"(80mm)<br>x 1.57"(40mm)<br>x 0.64"(16.5mm) |
| Material   | PC/ABS - 5VA Rating                             |

### Features & Benefits

- Tunable White / Dim-to-Warm Control
- 2400Hz Superior Dimming- Flicker Free to 0.1%
- Compatible with any CC LED Driver
- Autopair with RF Wall Switch
- Complies to IEEE and Title 24 Flicker Requirements
- 12.5A Max Power
- Current Limit Overload Protection
- No Minimum Load Requirement



# Wiring Overview

## Option 2 :DimTone Installation

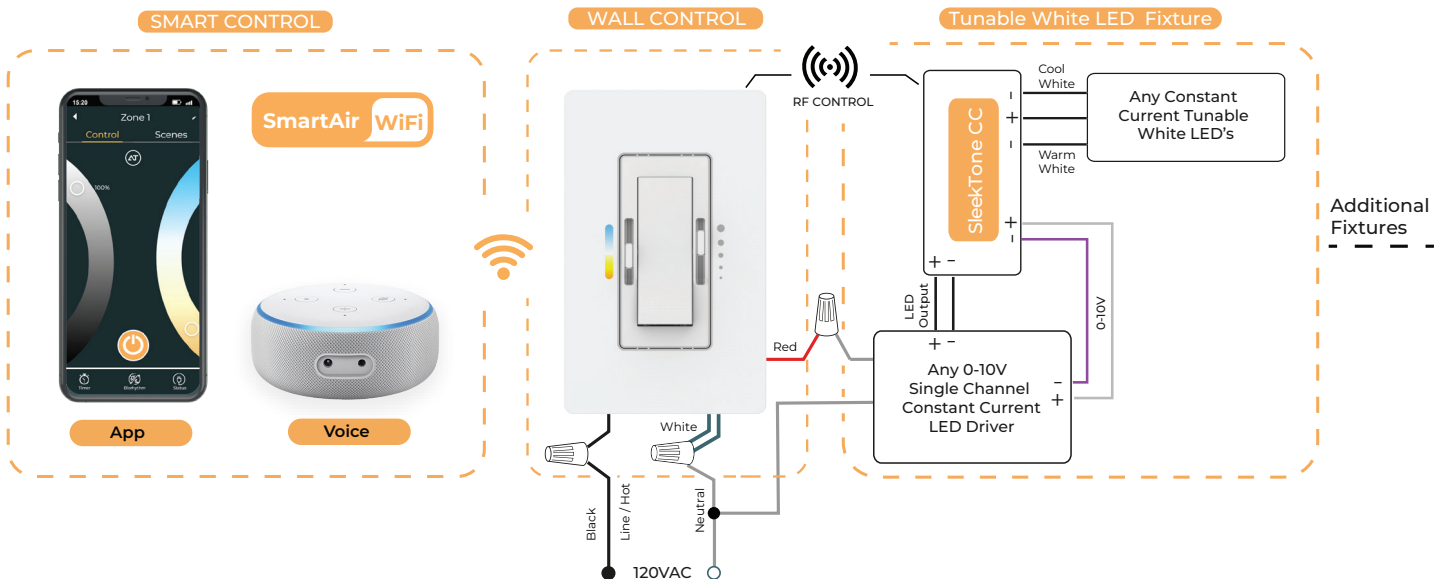

## Option 2 : WarmTech Installation

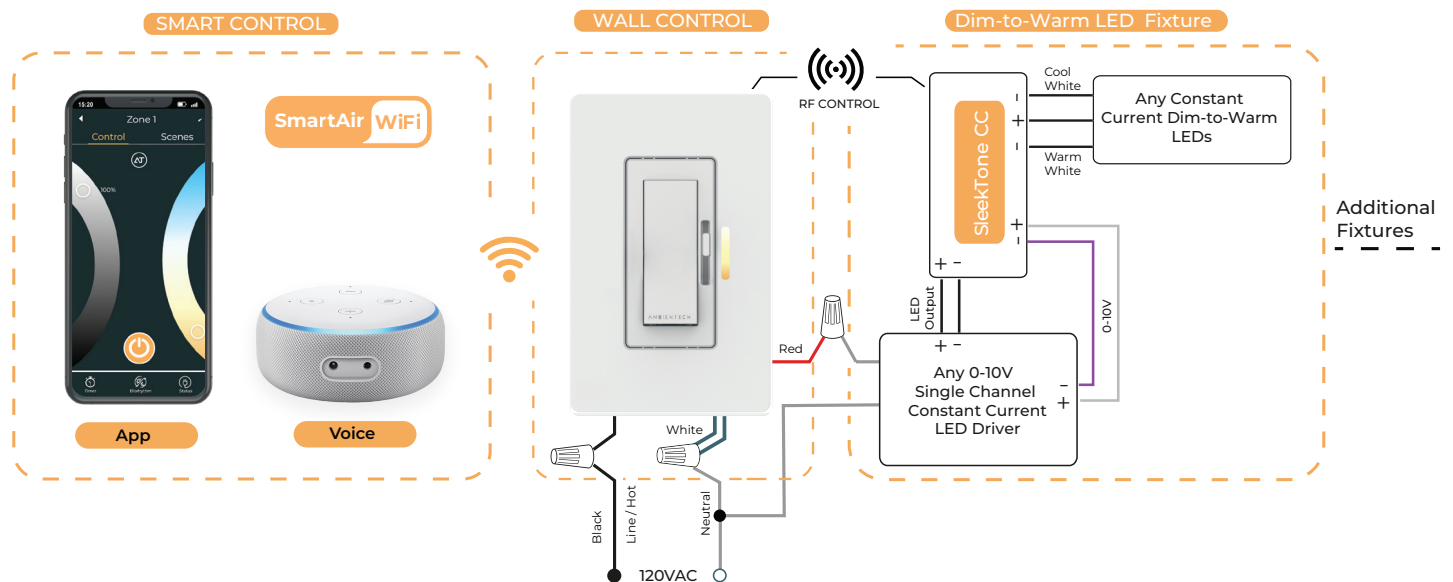



## Electrical Specifications

Ordering part numbers:

|              |                        | STCC-30W                           | STCC-45W | STCC-60W |
|--------------|------------------------|------------------------------------|----------|----------|
| Input        | Max Power              | 30W                                | 45W      | 60W      |
|              | Max Current            | 2A                                 |          |          |
|              | Rated Voltage          | 4-60VDC                            |          |          |
|              | Efficiency             | 98.5%                              |          |          |
| Output       | Output Voltage         | 4-60VDC                            |          |          |
|              | Max Current            | 2A                                 |          |          |
| Protection   | Over Current           | Hiccup mode                        |          |          |
|              | Short Circuit          |                                    |          |          |
|              | Over Temperature       |                                    |          |          |
| Enviromental | Ambient Oparating Temp | -30 °C - + 40 °C / -86°F - + 104°F |          |          |
|              | IP Rating              | 23                                 |          |          |

## Tunable White Curve

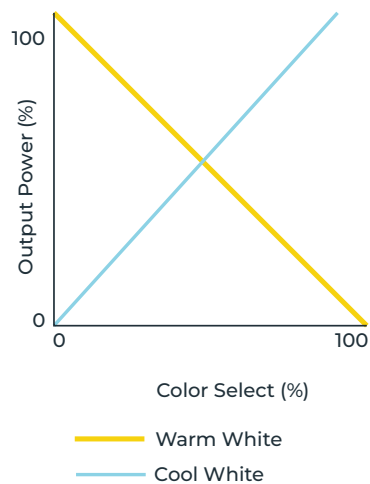

## Mechanical Specifications

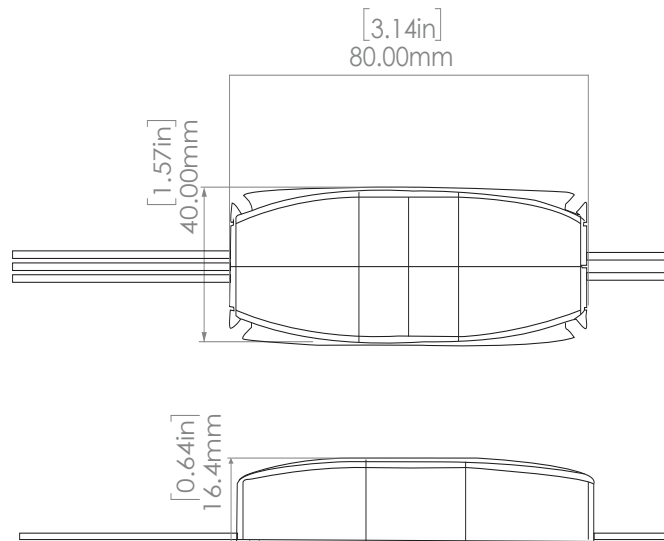



# Smart Air - App / Voice Control

SmartAir WiFi

Cloud Management

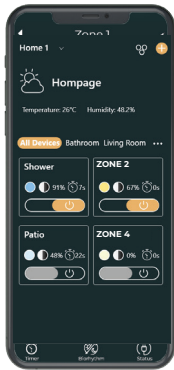

App



Voice

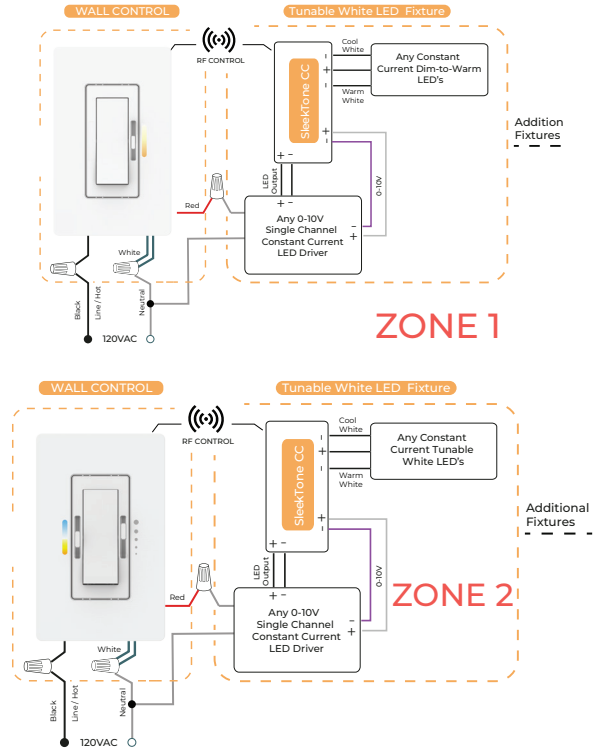

## App Features



Login



Tunable White



Dim to Warm



Dimming



Zone Grouping

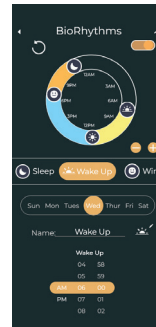

Biorhythm

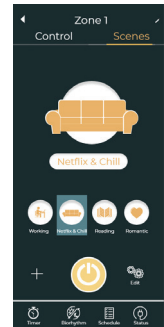

Save Scenes

+ More



works with the Google Assistant



WWW.AMBIENTECHINC.COM

Ver 2.7



[WWW.AMBIENTECHINC.COM](http://WWW.AMBIENTECHINC.COM)

Brooklyn Navy Yard  
63 Flushing Avenue  
Brooklyn, NY 11205

P: 347-334-6368  
E: [Sales@ambientechinc.com](mailto:Sales@ambientechinc.com)