

## DimTech

## Dimming Control System

DimTech offers a single-switch, end-to-end approach, eliminating redundant components and compatibility issues for superior dimming performance. With its wireless support, DimTech offers flicker free smooth dimming down to 0.1% before shutting off. Just plug and play to start customizing your lighting in moments. Device pairing takes place automatically when the light is first switched on, with no technical knowledge needed.



Dimmable  
0%-100%



RF CONTROL



LISTED  
DIMMER  
E507432

### IT'S AS SIMPLE AS THAT.



Automatic  
Pairing by Turning  
On the Switch



Up to  
700W



Wallplate Included  
in the Package



Standard  
Installation



## Features & Benefits

- No Compatibility Issues
- SmartAir - App / Voice Control
- Complies to IEEE and Title 24 Flicker Requirements
- Flicker-Free Soft Dimming - Down to 0.1%• Dim-to-off
- A Single Wall Switch Can Control Multiple LED Drivers
- Simple Installation with no Extra Wiring or Controllers
- 120VAC Wall Switch no Battery Required
- Classic Design to Match Existing Style Switches
- Fits US Standard Gang Box
- Fast Delivery – Shipping out of NY Fast Delivery

### Ordering Part Number Example:

P/N: TECH-WS x yy  
Model Color \*Smart

\*For Smart Type "SA " if not leave blank

### Colors



**W**  
White



**G**  
Grey



**O**  
Ivory



**B**  
Black



**C**  
Almond



**H**  
Hot

# WIRING

## OVERVIEW

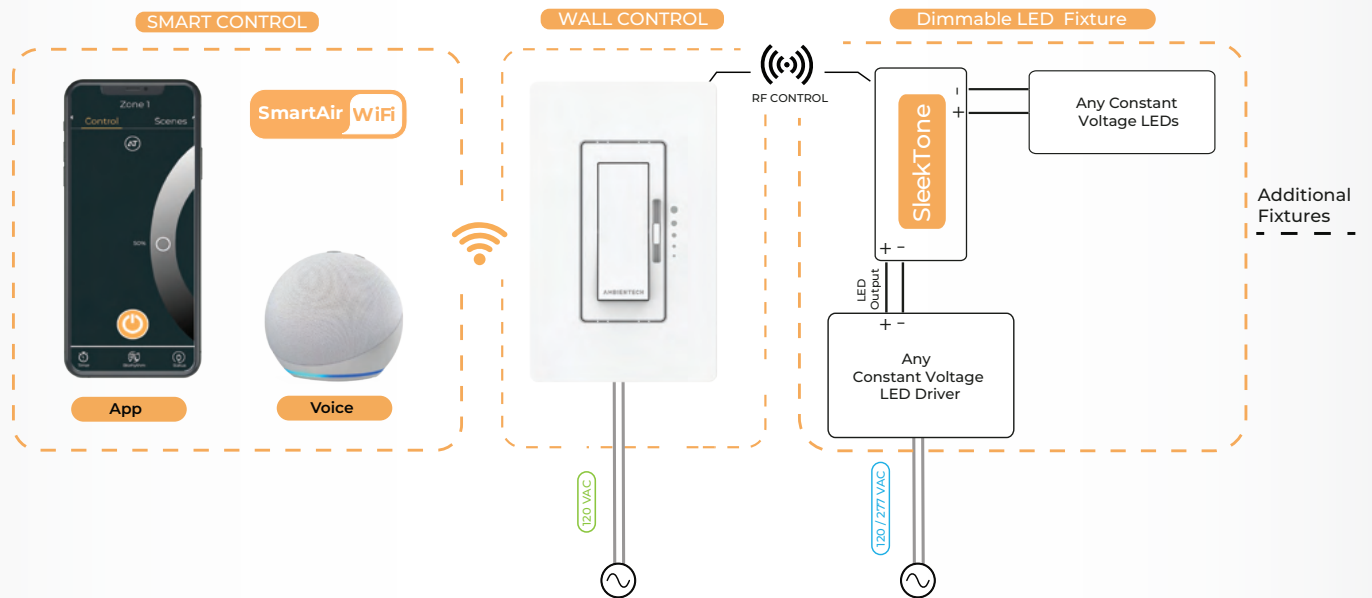
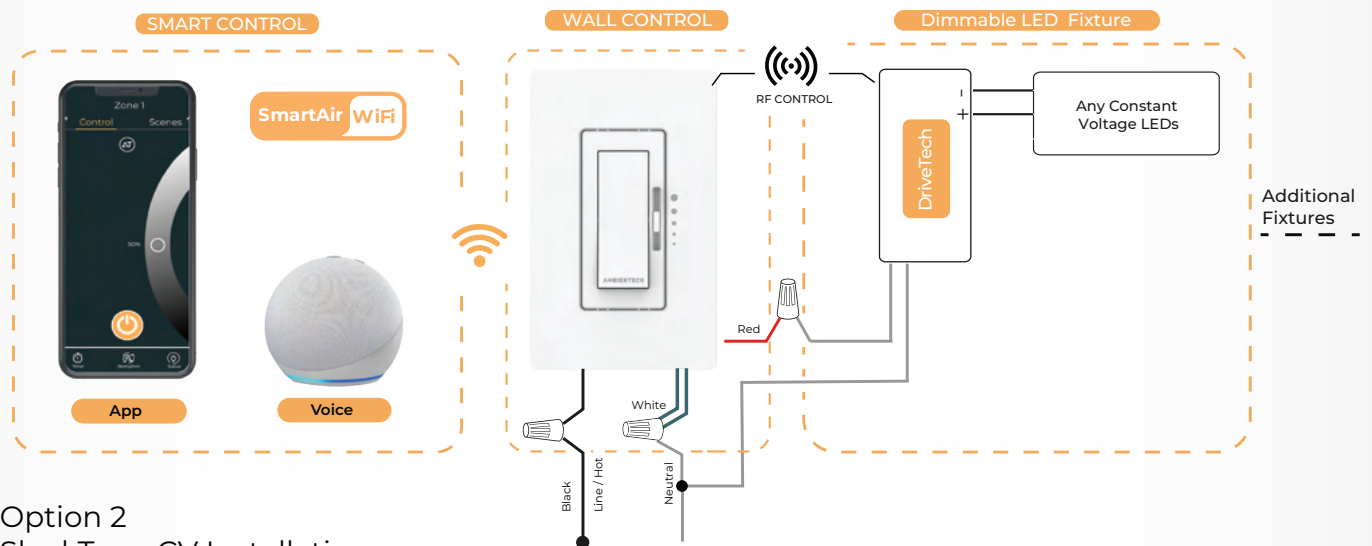

# ELECTRICAL

## SPECIFICATIONS

### Power & Ratings

Input	120VAC ~ 60Hz
Max Load	700W
Load Type	12/24VDC Tunable White LED's

### Compliance

UL Listed	UL1472 / CSA C22.2 184.1
FCC	Class B Part 15

### Environmental

Ambient Operating Temp	-30 °C - + 40 °C / -86°F - + 104°F
IP Rating	23

## Dimming Performance

Control Protocol	RF (auto pairing)
Dimming Range	0.1-100%
Dim to Off	Yes
Dimming Method	PWM (2400Hz)
Dimming Curve	Logarithmic (Default)

## Dimming Performance Graph

As defined in IEEE P1789, the results are presented with the low-risk in yellow and no observable effect in green.

Complies to Title 24 Flicker Requirements.

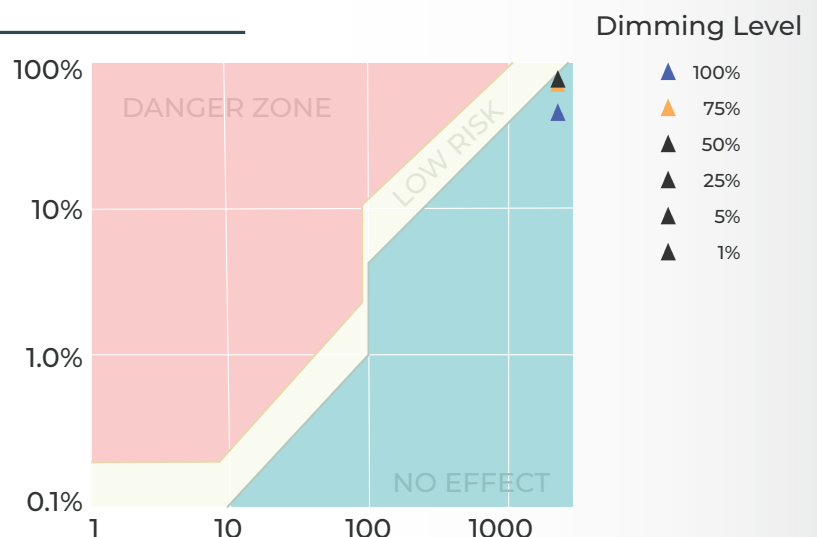

# MECHANICAL

## SPECIFICATIONS

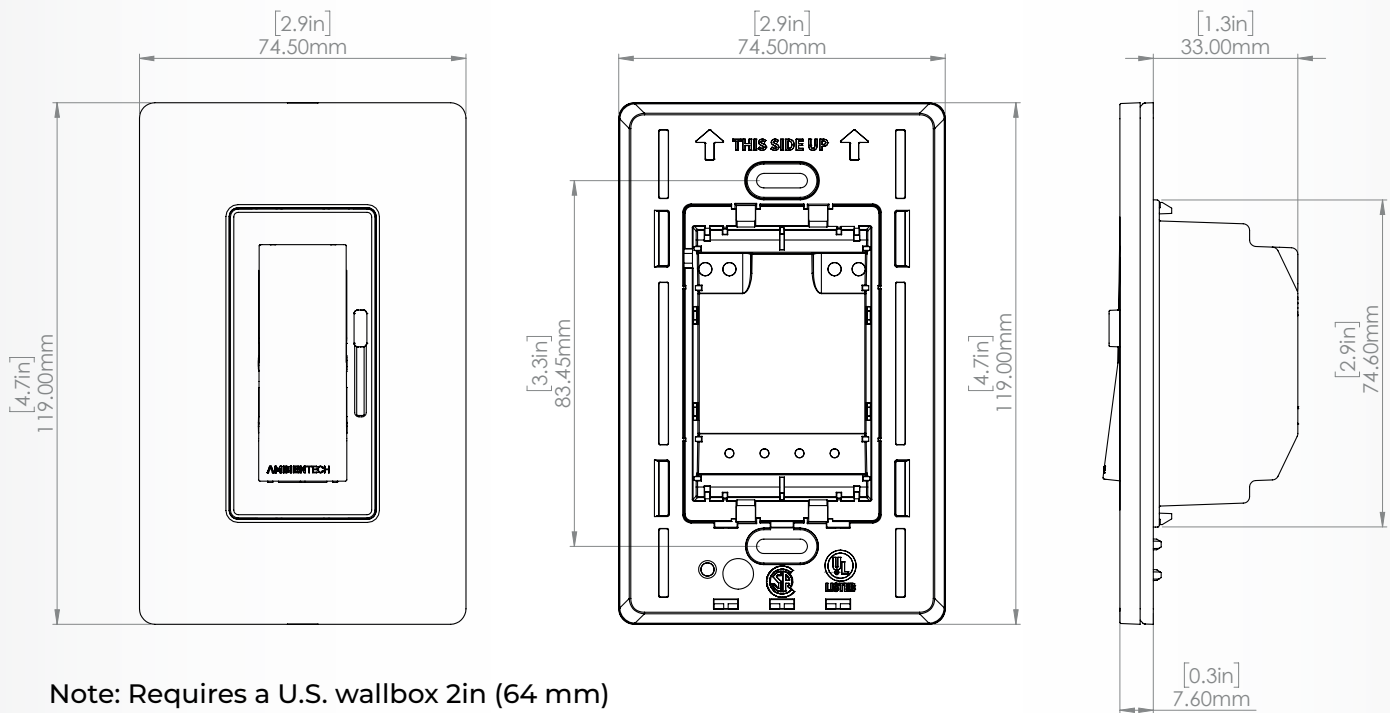

Note: Requires a U.S. wallbox 2in (64 mm) deep minimum.

Material	PC/ABS - 5VA Rating
Finish	White Glossy (Default)

# COMPATIBLE

## LEDS

The DimTech system is compatible with any 12/24VDC LED fixture.

LED Strip

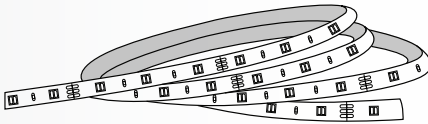

Linear

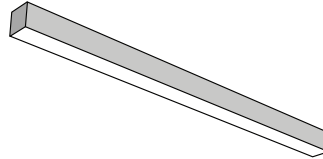

Downlight



## User Interface

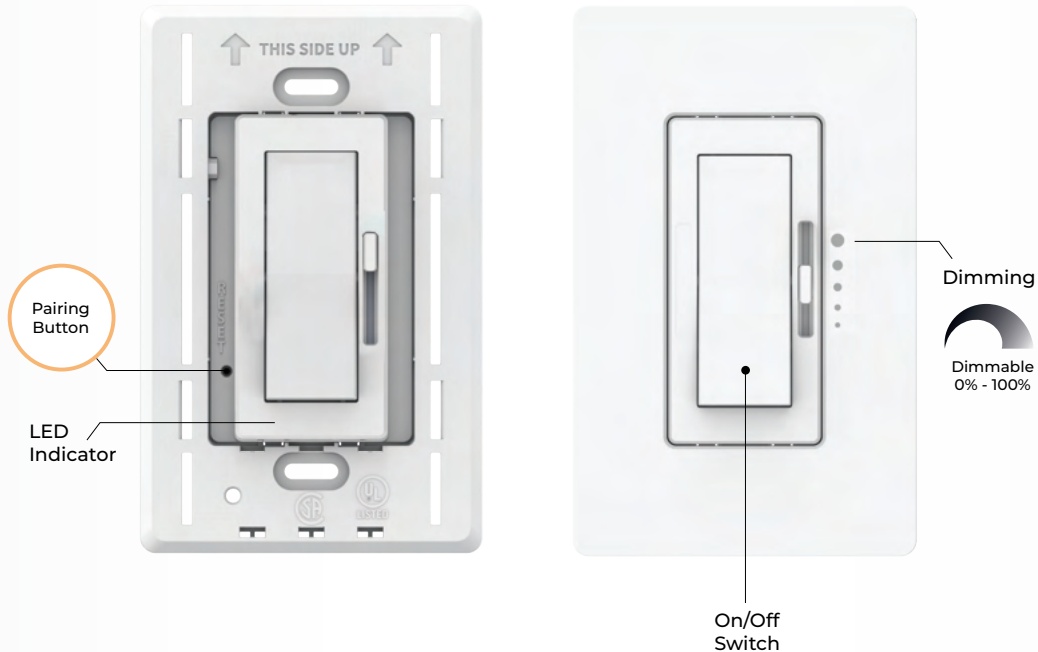

## Specification Submittal

Project Name:	Company Name:
Project Number:	Contact Name:
Part Number:	Email:

# SYSTEM

## FUNCTIONALITY

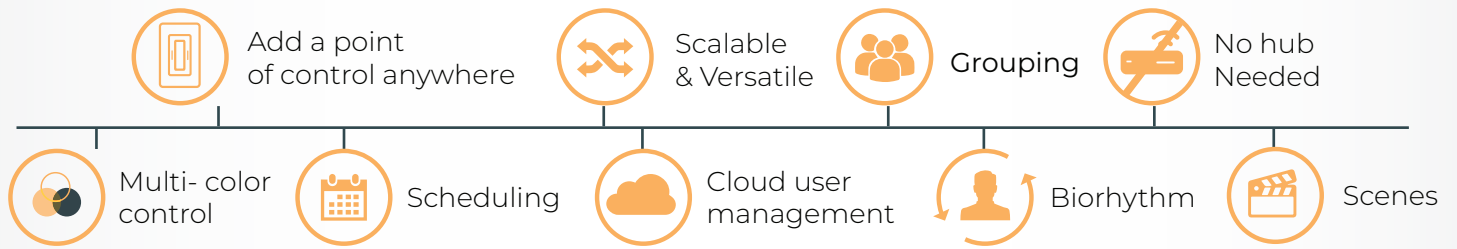

# SMART HOME

## INTEGRATION

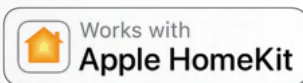

Download the SmartAir App



[WWW.AMBIENTECHINC.COM](http://WWW.AMBIENTECHINC.COM)

Brooklyn Navy Yard  
63 Flushing Avenue  
Brooklyn, NY 11205

P: 347-334-6368  
E: [Sales@ambientechinc.com](mailto:Sales@ambientechinc.com)